

Atlas Yorkshire

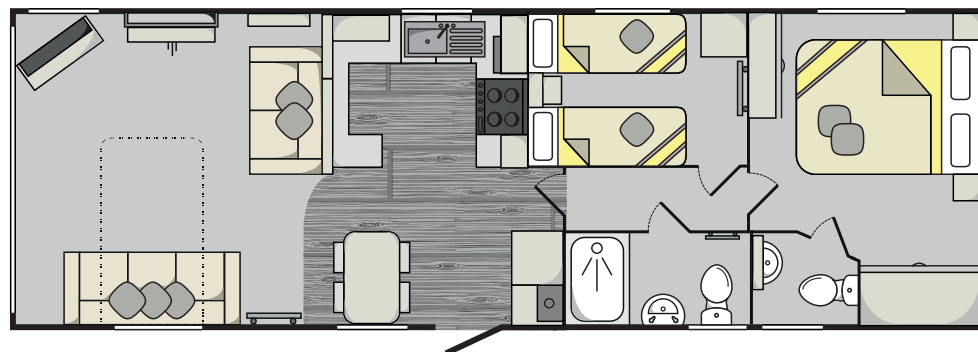

Floor plan

36 x 12 x 2 Bedroom
(sleeps 6)



Standard Features

Exterior & build quality

- Gas central heating
- uPVC double glazing
- Extra insulation
- Pre-galvanised chassis
- Exterior light

Bedroom

- Bedroom reading lights
- En-suite to master bedroom
- Upholstered tub stool in master bedroom
- Lift-up storage bed to master bedroom

Kitchen / Dining

- Integrated fridge/freezer
- Integrated microwave
- Gas 4 ring hob and oven
- Free standing dining table and 4 dining chairs
- Recirculating extractor hood in kitchen

Optional Extras

- Optional front French doors
- Environmental green aluminium cladding

Lounge

- Coffee table
- Free-standing floor lamp
- TV point above fire with booster
- USB sockets
- Pull out sofa-bed
- Domestic quality fireplace

The Holiday Home Centre

The home of caravan holidays

The Holiday Home Centre,
Beverley Rd, Beeford,
YO25 8AD

T: 01262 481210

E: info@theholidayhomecentre.com

www.theholidayhomecentre.com



Find us here

The Holiday Home Centre

The home of caravan holidays

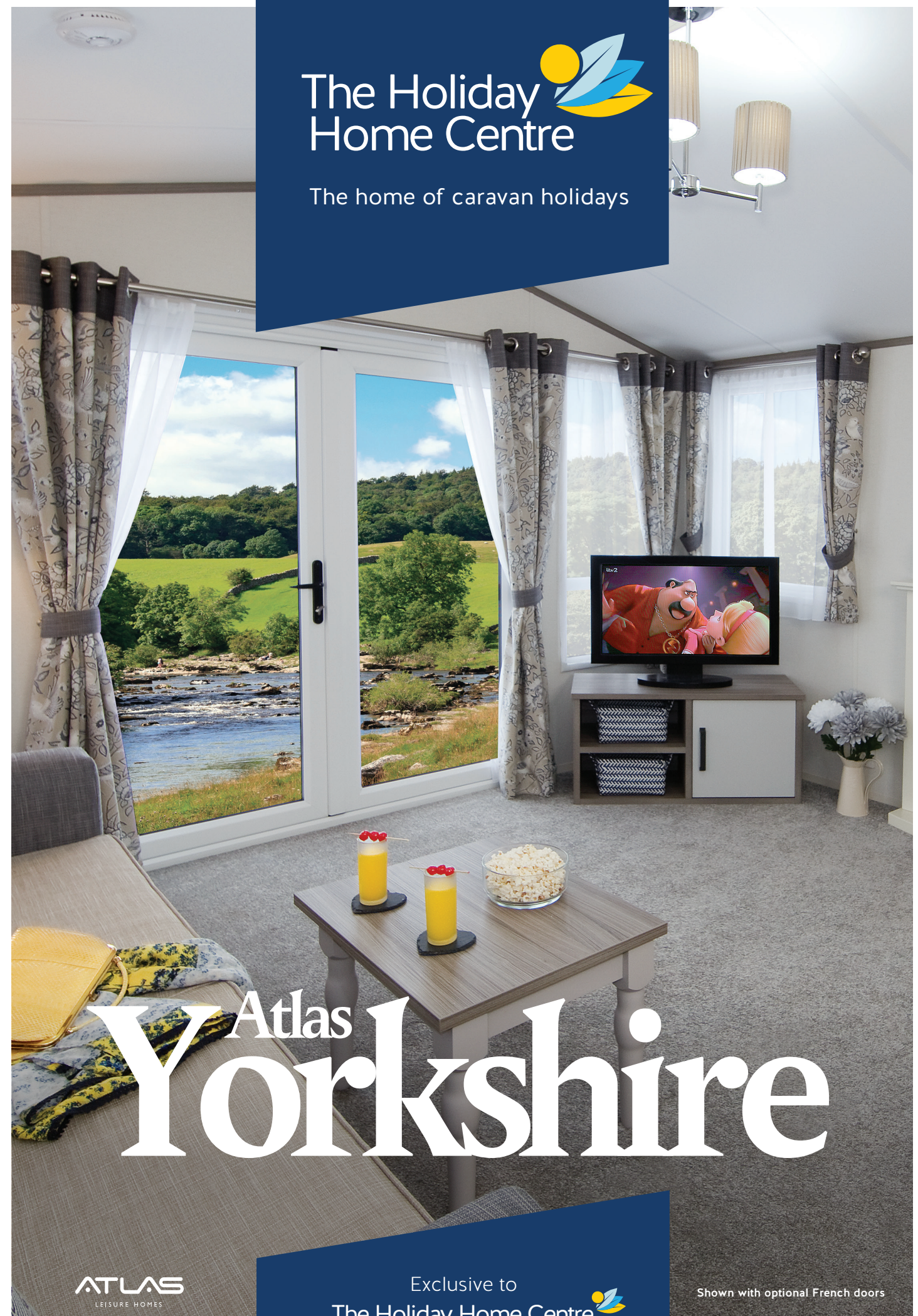

Atlas Yorkshire

ATLAS
LEISURE HOMES

Exclusive to
The Holiday Home Centre

Shown with optional French doors



Atlas Yorkshire

Stylish meets practical in this brand new, well-specified holiday home.



Working in conjunction with Atlas Leisure Homes we wanted our first 'special' Holiday Home to be visually appealing as well as offering the sort of value our customers will know and love. Step into the Atlas Yorkshire and you are greeted by a bright airy interior that, like its namesake, has hidden depth and qualities often overlooked at first glance.

The Atlas Yorkshire provides open plan living at its best. Light, cool tones, comfortable furnishings and quality finishing touches can be found wherever you look in this stunning holiday home. Whilst you are enjoying the look and feel of this stunning holiday home you can relax knowing that, behind the scenes, as standard the Yorkshire comes with gas central heating, uprated insulation, uPVC double glazing and a pre-galvanised chassis.

